



2 Rasmussen Drive Templestowe VIC

4 🏠 3 🚿 6 🚗

From the long, sweeping driveway through an acre of native gardens with a tennis court and enticing aquamarine swimming pool, this two storey home comprises of a unique design offering outstanding flexibility in accommodation with 2 separate wings, to one side there is a bright spa bathroom and 3 robed double bedrooms including a master with chic ensuite. The other wing is fully self-contained with an open-plan living zone, meals and modern kitchen, leading to a double bedroom with walk-in robe and ensuite, both wings enjoy access to the long, sunny north balcony. Beautifully renovated kitchen equipped with premium appliances and stone bench tops overlooking the alfresco, as well as an expansive open-plan sitting room streaming out to a 2nd impressive undercover alfresco, designed for the year-round

Type : House

View : <https://www.halfapercen.com.au/7086616>



Celeste Cuzzolin
0395271211



Susie Minski
0395271211

[For full version visit the website](https://www.halfapercen.com.au)

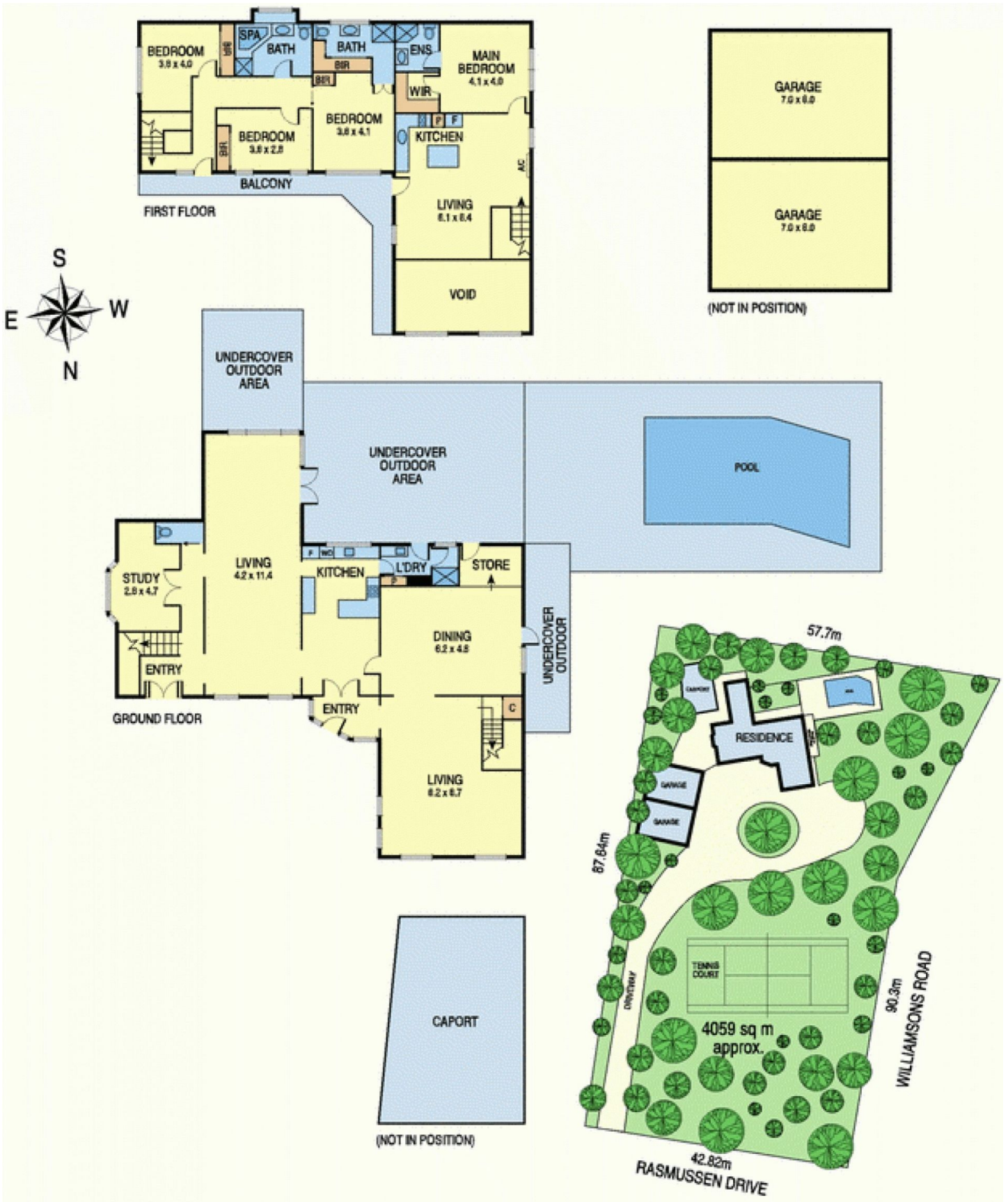

NOTE: Every precaution has been taken to verify the accuracy of the above details. However, prospective purchasers are advised to make their own enquiries. Fletchers gives no warranty to the above and expressly disclaims all liability for any loss or damage, whatever the cause which may arise from any person acting on any such statements.