



13A Emma Street Caulfield South, VIC



4



4



2

AN AMAZING MODERN FAMILY HOME WITH 4 BEDROOMS & 4 BATHROOMS

Lead a lifestyle of unsurpassed ease in this meticulously presented home where classic style & contemporary design meets a first class family lifestyle. Presenting an enticing combination of stylish living zones superb alfresco living with two outdoor spaces to enjoy & the added bonus of each bedroom boasting its own private ensuite - you'll love every aspect of this immaculately presented home. Polished timber floors greet you on entry & flow down the hallway accessing a comfortable guest/fourth bedroom/study with built-in robes & dual access ensuite, a northerly oriented formal lounge with electric fireplace & sliding doors out to a sunny paved side courtyard, all culminating in the epicentre of the home - a vast open plan living & dining space flooded with an abundance of natural light & bi-fold doors opening out to an alfresco deck & rear garden oasis, creating the perfect indoor-outdoor space for family relaxing & entertaining, all further complemented by a modern stone kitchen with a suite of stainless steel appliances (including dishwasher), mirrored splashbacks & an abundance of soft close joinery. Upstairs delivers a handy landing retreat, main bedroom with garden outlook, large dressing room/walk-in robe & luxe ensuite with bath &

Celeste Cuzzolin

Susie Minski

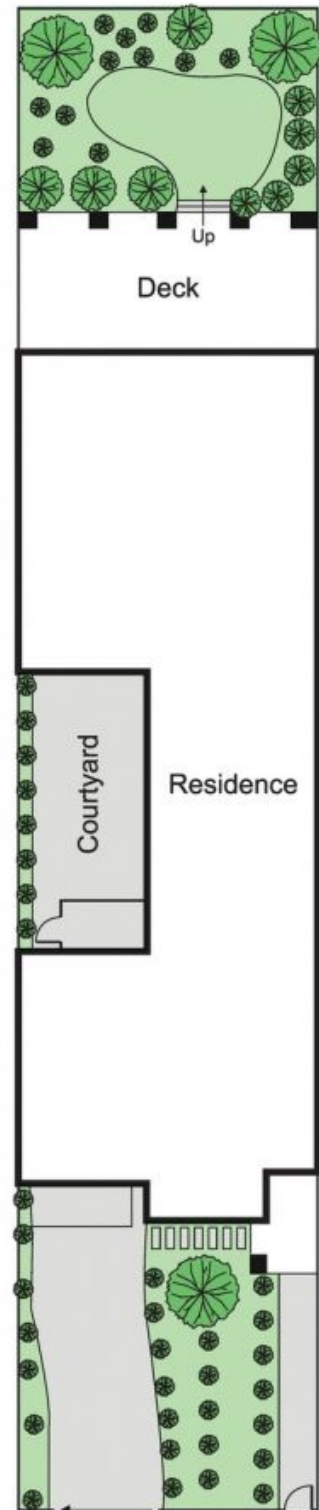
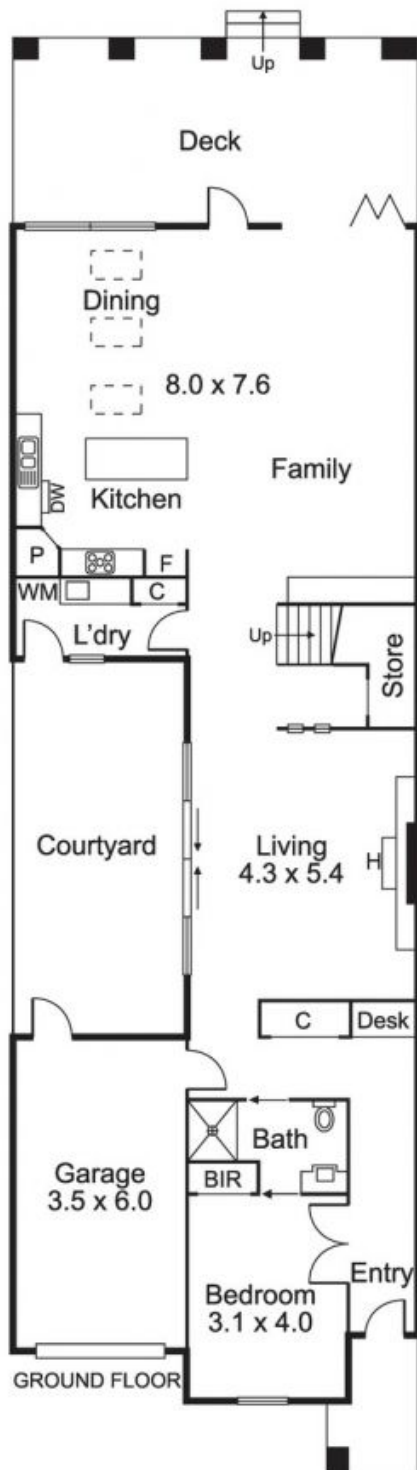

Disclaimer: The measurements and/or dimensions of both the land and property as well as any internal measurements and/or dimensions of any rooms are approximate and may not be accurate. Prospective purchasers should carry out their own measurements and enquiries and engage the services of a licensed surveyor. To the maximum extent permitted by law, Gary Peer & Associates Pty Ltd gives no guarantee or warranty whatsoever as to the accuracy or otherwise of the measurements and dimensions set out (including but not limited to errors or omissions) and expressly disclaims all liability for any loss or damage, whatever the cause, which may arise from any person acting and/or relying on such measurements and dimensions.